

Item 1
(1:10)

Item 8
(1:5)

Item 4
(1:2)

Item 3
(1:2)

Item 5
(1:2)

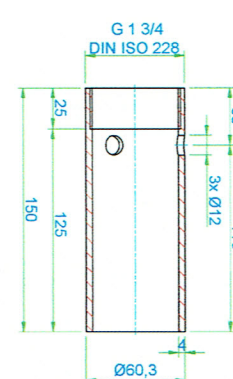
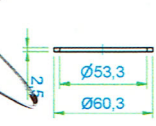
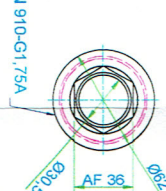
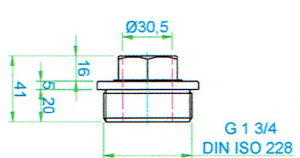

APPROVED FOR FABRICATION

QC 02

R. M. SCARCE

NO.	DATE	DESCRIPTION	BY	CHKD	DATE	DESCRIPTION	BY	CHKD
01	15/11/14	DETAIL V. MODIFIED	172	180	14/01			
02	15/11/14	DETAIL V. MODIFIED	172	180	14/01			
03	15/11/14	DETAIL V. MODIFIED	172	180	14/01			
04	15/11/14	DETAIL V. MODIFIED	172	180	14/01			
05	15/11/14	DETAIL V. MODIFIED	172	180	14/01			
06	15/11/14	DETAIL V. MODIFIED	172	180	14/01			
07	15/11/14	DETAIL V. MODIFIED	172	180	14/01			
08	15/11/14	DETAIL V. MODIFIED	172	180	14/01			
09	15/11/14	DETAIL V. MODIFIED	172	180	14/01			
10	15/11/14	DETAIL V. MODIFIED	172	180	14/01			
11	15/11/14	DETAIL V. MODIFIED	172	180	14/01			
12	15/11/14	DETAIL V. MODIFIED	172	180	14/01			
13	15/11/14	DETAIL V. MODIFIED	172	180	14/01			
14	15/11/14	DETAIL V. MODIFIED	172	180	14/01			
15	15/11/14	DETAIL V. MODIFIED	172	180	14/01			
16	15/11/14	DETAIL V. MODIFIED	172	180	14/01			
17	15/11/14	DETAIL V. MODIFIED	172	180	14/01			
18	15/11/14	DETAIL V. MODIFIED	172	180	14/01			
19	15/11/14	DETAIL V. MODIFIED	172	180	14/01			
20	15/11/14	DETAIL V. MODIFIED	172	180	14/01			

Camden Power Station

Secondary Air - Front Flange

0.36/21195

QC 02